

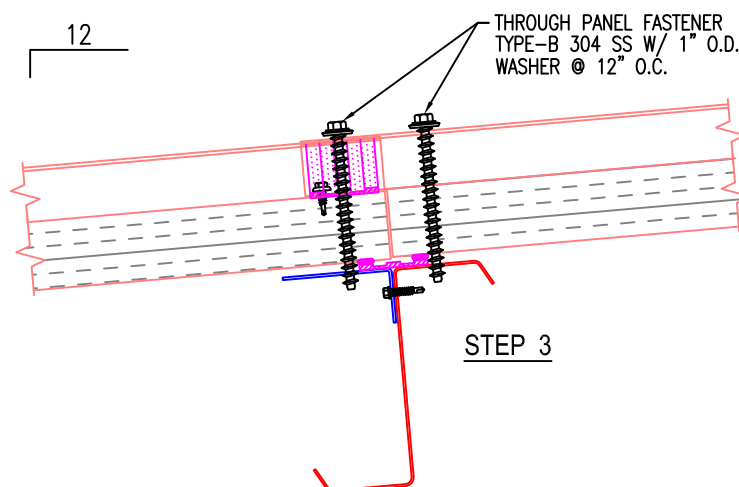

EXCEPTIONAL[®] Metals

NOTE:
APPLY TRIPLE BEAD TAPE SEALER ALONG THE JOINT BETWEEN THE PURLIN AND THE END LAP SUPPORT ANGLE. APPLY CONTINUOUS BEADS OF NON-SKINNING BUTYL SEALANT UPSLOPE AND DOWNSLOPE OF THE CENTER OF THE END LAP SUPPORT ANGLE ON TOP OF THE TRIPLE BEAD TAPE SEALER

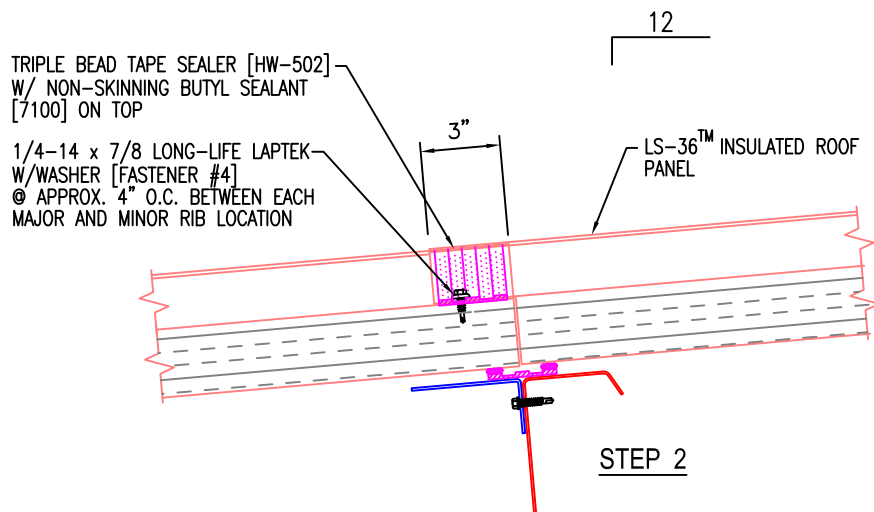
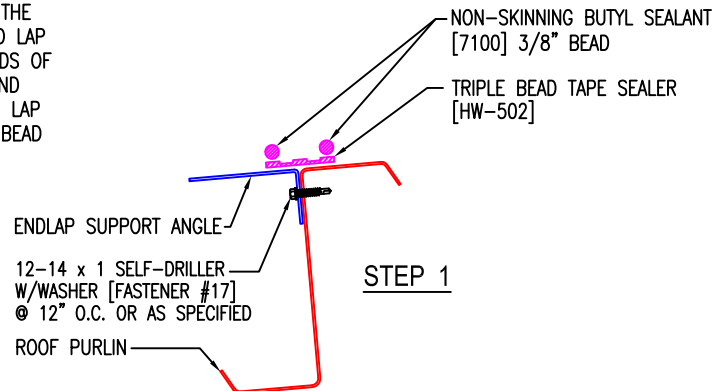

REVISED: 07/24/2018

AUTHOR BVANOCHT

SCALE: NONE

INSULATED ROOF PANELS

EM LS-36™ INSULATED ROOF PANEL

END-LAP DETAIL