

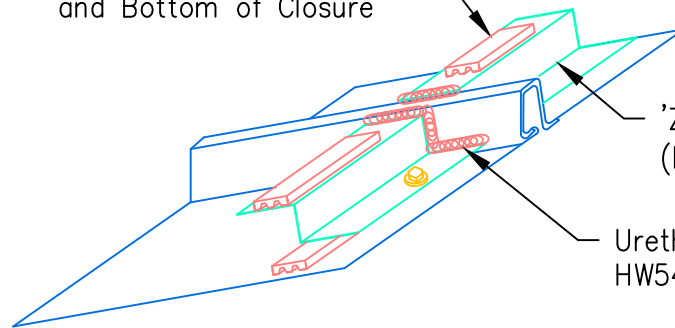

EXCEPTIONAL[®] Metals

Tri-Bead Tape Sealer
 $\frac{7}{8}$ " x $\frac{3}{16}$ " HW504 Top
 and Bottom of Closure



'Z' Closure AG-470
 (Field cut to fit panel)

Urethane Tube Sealant
 HW540 at Closure Ends

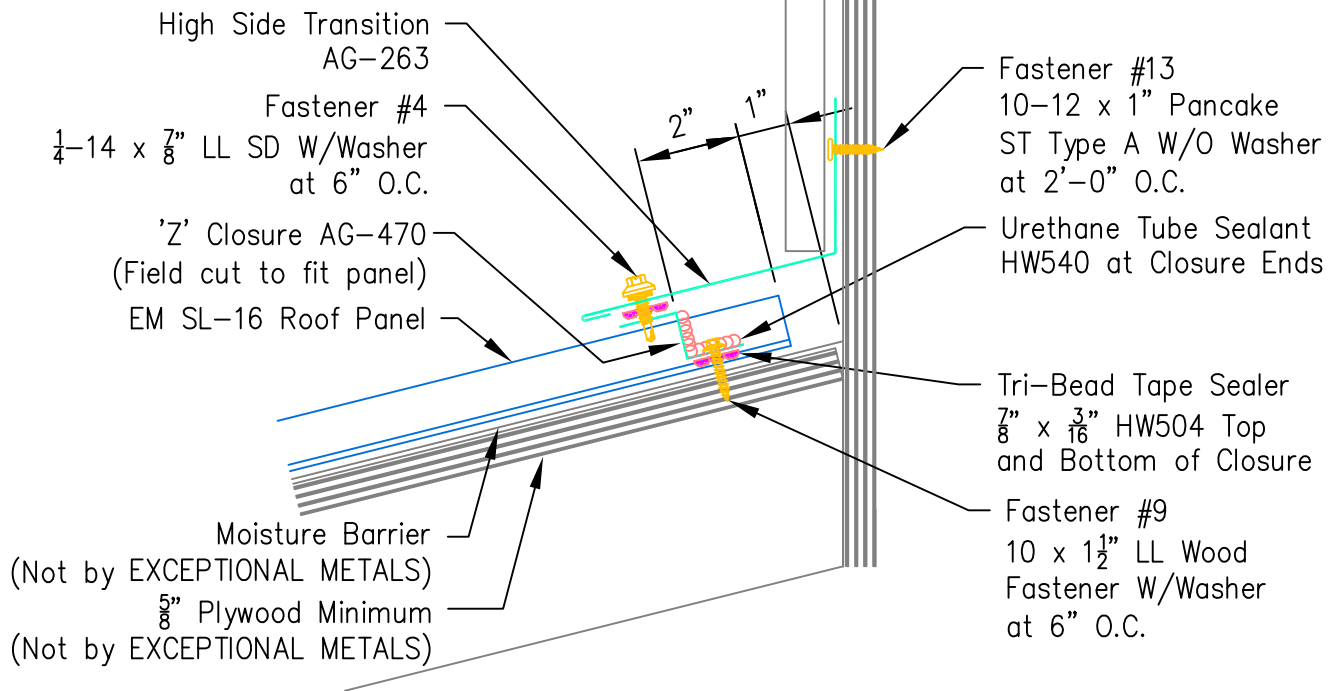

Fastener #13
 10-12 x 1" Pancake
 ST Type A W/O Washer
 at 2'-0" O.C.

Urethane Tube Sealant
 HW540 at Closure Ends

Tri-Bead Tape Sealer
 $\frac{7}{8}$ " x $\frac{3}{16}$ " HW504 Top
 and Bottom of Closure

Fastener #9
 10 x 1 1/2" LL Wood
 Fastener W/Washer
 at 6" O.C.

REVISED: 07/19/2018

CONCEALED FASTENING ROOF PANELS

AUTHOR BVANOCHT

EM SLIMLINE[®]

SCALE: NONE

PARAPET HIGH EAVE WITH EXPOSED FASTENERS