



# Snap Coping

## Product Data Sheet

### Product Description

The Snap Coping offers a complete finish to any parapet wall with no exposed fasteners. The system utilizes 16-gauge cleat segments spaced at 60" centers.

- Fabricated in 10 foot lengths; widths are customized to fit the wall.
- 16" cleat segments are fabricated in 16 gauge galvanized.
- 6" Concealed splice plate eliminates exposed fasteners and allows for thermal movement.
- Riveted inside and outside miters and end caps are available.
- Minimum 4" face, 8" top, 3" back
- LEED® compliant.

### Installation

1. A wood nailer attached to the top of the parapet wall is required.
2. This nailer should be attached to the wall in accordance with ANSI/SPRI ES-1.
3. Install in accordance with EXCEPTIONAL® Metals' Detail #6054 and Installation #6054.
4. Any deviation from the requirements set forth in detail drawings must be pre-approved, in writing, by the EXCEPTIONAL Metals' Technical Department.

### Codes and Standards

- ANSI/SPRI ES-1 Compliant up to 16" width.
- Meets TAS 111-95 Test with 12" wall dimension and 4" face with 3" back.
- FM-Approved.

### Warranty

EXCEPTIONAL Metals offers a finish and substrate warranty. Contact the membrane manufacturer for any additional warranty that may be offered.

### Technical Services

Product samples, detail sheets, color chips, and color chart are available for your submittal package. For assistance with questions or submittals, contact your local representative or call EXCEPTIONAL Metals.

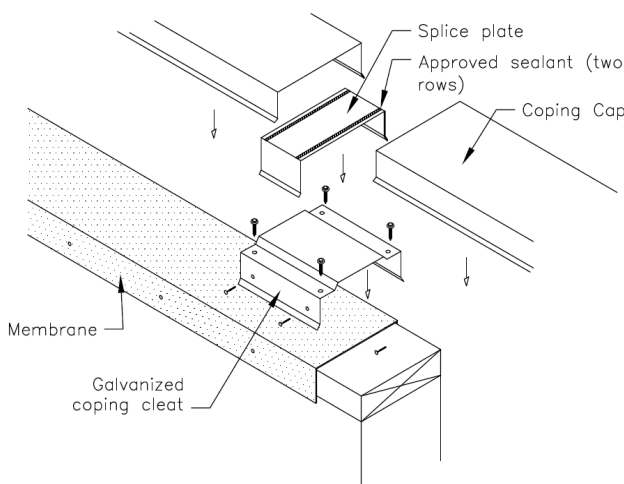
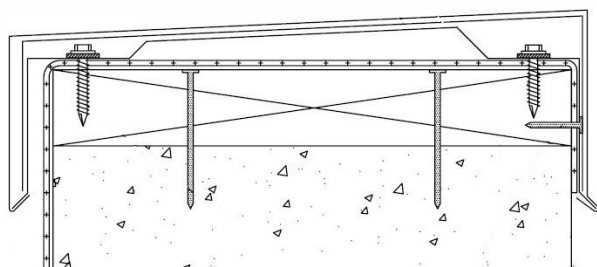

Material	Gauge	Finish
Aluminum	.040	Mill or Kynar®
Stainless Steel	24-gauge	N/A
Bonderized Steel	24-gauge	N/A
Galvalume®	24-gauge	Mill or Kynar®

For more information give us a call  
or visit our website today.

800-248-0280 • [exceptionalmetals.com](http://exceptionalmetals.com)