



Canted Coping

Product Data Sheet

Product Description

The Canted Coping offers a complete finish to any parapet wall. Coping is pitched to the inside of the roof plane ensuring that water will drip back towards the roof instead of down the front of the building. The system uses a continuous cleat for high wind up-lift resistance.

- Fabricated in 10' lengths; widths customized as required.
- Pre-punched continuous cleats help ensure proper fastener placement; back leg is secured with grommeted fasteners.
- 6" concealed splice plate allows for expansion and contraction.
- Riveted inside and outside miters and end caps are available.
- Not recommended for walls wider than 16".
- LEED® compliant.
- ANSI/SPRI ES-1 Compliant up to 16" wall width.

Installation

1. A wood nailer attached to the top of the parapet wall is required.
2. This nailer should be attached to the wall in accordance with ANSI/SPRI ES-1.
3. Install in accordance with EXCEPTIONAL® Metals' Detail #6052 and Installation #6052.
4. Any deviation from the requirements set forth in detail drawings must be pre-approved, in writing, by the EXCEPTIONAL Metals' Technical Department.

Warranty

EXCEPTIONAL Metals offers a finish and substrate warranty. Contact the membrane manufacturer for any additional warranty that may be offered.

Technical Services

Product samples, detail sheets, color chips, and color chart are available for your submittal package. For assistance with questions or submittals, contact your local representative or call EXCEPTIONAL Metals.

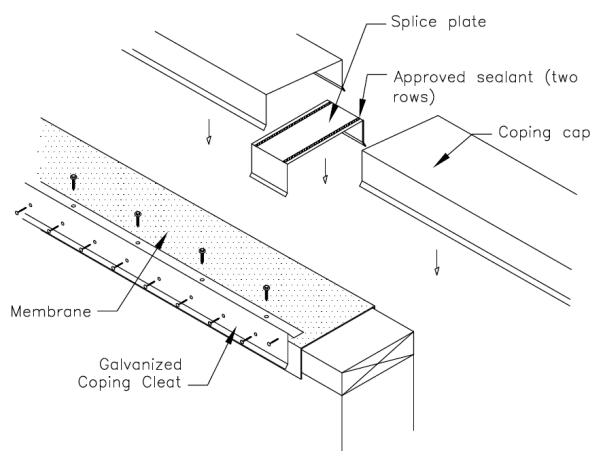
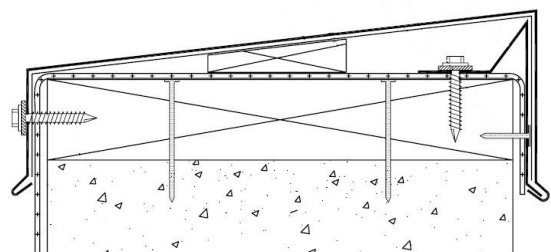

Material	Gauge	Finish
Aluminum	.040	Mill or Kynar®
Stainless Steel	24-gauge	N/A
Bonderized Steel	24-gauge	N/A
Galvalume®	24-gauge	Mill or Kynar®
Copper	16 oz.	Mill

For more information give us a call
or visit our website today.

800-248-0280 • exceptionalmetals.com