



Gravel Stop Cover

Product Data Sheet

Product Description

The 2" and 4" Gravel Stop Cover provides a professional finish that is used in conjunction with the Duro-Last® 2" and 4" vinyl gravel stop.

- Manufactured from various metals (see chart below) in 10' lengths; 2" and 4" widths.
- End-notched to provide piece-to-piece interlocking.
- Ready-to-assemble inside and outside corners are available.
- LEED® compliant.

Installation

1. A wood nailer is required if 1" or greater of insulation is used.
2. This nailer should be attached to the wall in accordance with ANSI/SPRI ES-1.
3. Install in accordance with EXCEPTIONAL® Metals' detail drawings #3100, #3520, and #3530.
4. Any deviation from the requirements set forth in detail drawings must be pre-approved, in writing, by the EXCEPTIONAL Metals' Technical Department.

Codes and Standards

- ANSI/SPRI ES-1 Compliant with 24-gauge Galvalume® cover.
- FM Approved.

Warranty

EXCEPTIONAL Metals offers a wide range of warranty coverage for products including paint and finish.

Technical Services

Product samples, detail sheets, color chips, and color chart are available for your submittal package. For assistance with questions or submittals, contact your local representative or call EXCEPTIONAL Metals.

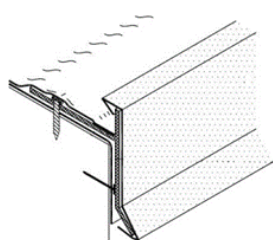

2" Gravel Stop Cover

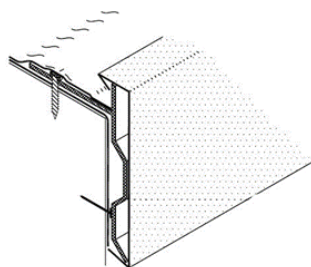

4" Gravel Stop Cover

Material	Gauge	Finish
Aluminum	.040	Mill or Kynar®
Stainless Steel	24-gauge	N/A
Bonderized Steel	24-gauge	N/A
Galvalume®	24-gauge	Mill or Kynar®
Copper	16 oz.	Mill

For more information give us a call
or visit our website today.

800-248-0280 • exceptionalmetals.com