



# 2-Piece Snap-On Compression

## Product Data Sheet

### Product Description



The 2-Piece Snap-On Compression system may be used as a perimeter flashing for single-ply roofing systems. The system consists of a 24-gauge Galvalume® base and a snap-on metal cover.

### Features

- Base and cover is fabricated in 10' lengths; 3" – 8" widths.
- Cover is double-hemmed to prevent roof material from excessive wear.
- Ready-to-assemble inside and outside corners are available.
- This edge metal is also available in a flat face to match the 2 piece Flex.
- LEED® compliant.

### Installation

1. A wood nailer is required if 1" or greater of insulation is used.
2. This nailer should be attached to the wall in accordance with ANSI/SPRI ES-1.
3. Install in accordance with EXCEPTIONAL® Metals' Detail #3110.
4. Any deviation from the requirements set forth in detail drawings must be pre-approved, in writing, by the EXCEPTIONAL Metals' Technical Department.

### Codes and Standards

- ANSI/SPRI ES-1 Compliant with 3" – 8" base and cover.
- Meets TAS 111-95 Test with 4" and 6".
- FM Approval on 4" and 6".

### Warranty

EXCEPTIONAL Metals offers a finish and substrate warranty. Contact the membrane manufacturer for any additional warranty that may be offered.

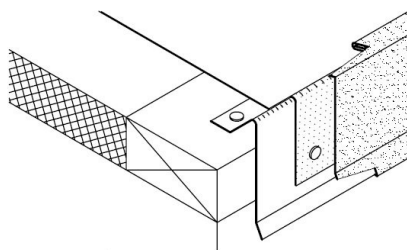
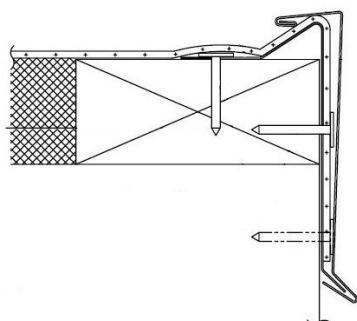

Material	Gauge	Finish
Aluminum	.040	Mill or Kynar®
Stainless Steel	24-gauge	N/A
Bonderized Steel	24-gauge	N/A
Galvalume®	24-gauge	Mill or Kynar®
Copper	16 oz.	Mill

For more information give us a call  
or visit our website today.

800-248-0280 • [exceptionalmetals.com](http://exceptionalmetals.com)