

FIXED HIGH EAVE WITH MODIFIED J - CHANNEL

DETAIL NO.
EXM-HE-2
NOT TO SCALE

MATERIAL : STEEL/ALUMINUM

ACCEPTABLE SYSTEMS: DefendEX SS1500, DefendEX SS2000, DefendEX SL1500, DefendEX SL1750

ISSUE / REVISION DATE:

02/09/2026

(866) 337-4599 www.exceptionalmetals.com

MAXIMUM WARRANTY: 20 YEARS

MODIFIED J-CHANNEL, FILL
HEM OF FLASHING AND
SPACE BETWEEN
J-CHANNEL & PANEL SEAM
w/ URETHANE SEALANT

APPROPRIATE
FASTENER; 24" (609.6 mm)
O.C. MAX.

APPROPRIATE
ANCHORING FASTENER

APPROVED
UNDERLAYMENT

HIGH EAVE FLASHING

WOOD NAILER

HIGH EAVE CLEAT

APPROPRIATE
FASTENER: 8" (203.2 mm)
O.C. MAX.

FIELD CRIMP WITH
6" (152.4 mm) DUCK
BILL PLIERS

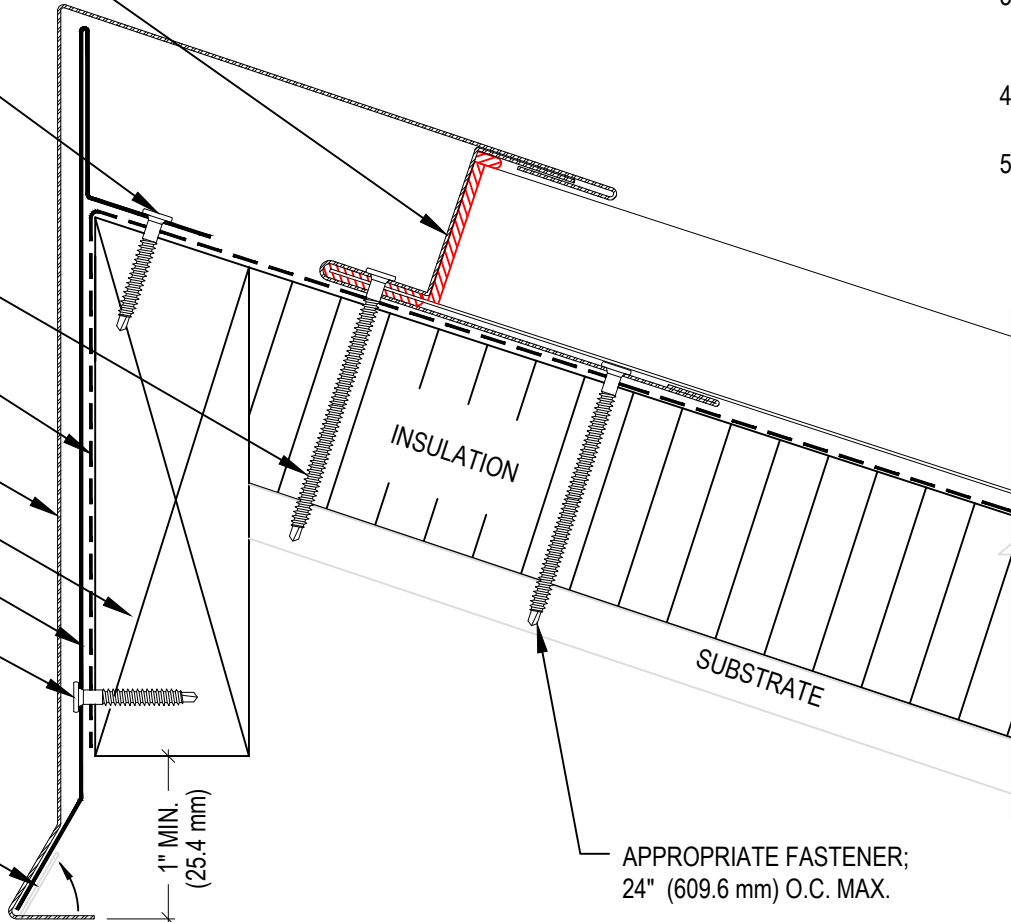

NOTE:

1. REFER TO THE EXCEPTIONAL METALS WEBSITE FOR MOST CURRENT INFORMATION.
2. REFER TO TECHNICAL INFORMATION SHEETS FOR FASCIA SIZES, ACCESSORIES, AND FINISHES AVAILABLE.
3. WOOD NAILER MUST BE INSTALLED TO MEET APPLICABLE BUILDING CODES OR 200 LB PER LINEAR FOOT MINIMUM IN ANY GIVEN DIRECTION.
4. REFER TO THE EXCEPTIONAL METALS WEBSITE FOR FASTENER COMPATIBILITY WITH METAL.
5. APPLICATION DETAILS ARE FOR ILLUSTRATION PURPOSES ONLY AND MAY NOT BE APPROPRIATE FOR ALL BUILDING DESIGNS AND CONDITIONS.

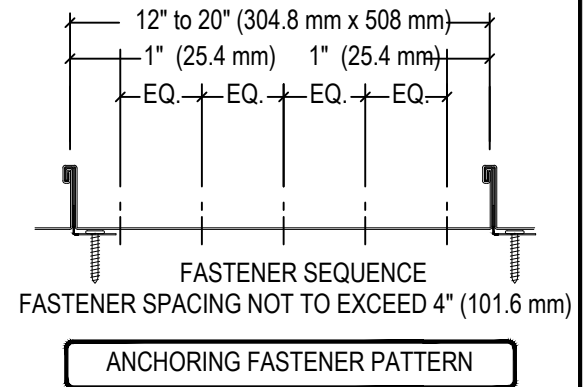

**THIS DETAIL APPLIES TO ALL
WARRANTED DEFENDEX ROOF
SYSTEMS (SS1500, SS2000, SL1500,
SL1750)**

**FOR WARRANTY PERIODS GREATER THAN
20 YEARS REFER TO METAL QUICK SPECS
FOR MINIMUM REQUIREMENTS.**